

JBF-1 & JBF-2 Series

Our standard JBF-1 and JBF-2 are available in 6 bar and 10 bar. The housings are very suitable for use in brackish and seawater applications and also have a high chemical resistance. The housings are designed according to the PED. The position of the inlet and outlet can be changed to the customers requirements. Options: valves, pressure gauges, automatic air release. LFS calculates the chemical, temperature and pressure influences on the housing.

Ordering code: JBF-2-PP6E-50F

Type

JCF = Cartridge
JBF = Bag filter
JSF = Strainer
JDF = High flow

Size Bag

Material

PP = Polypropylene
HD-PE = Polyethylene
PVDF = Polyvinylidene fluoride

DN + Connection

F = Flange
FT = Female Thread
MT = Male Thread

O-ring

E = EPDM
V = FPM

Pressure

6 = 6 bar @ 40° C
10 = 10 bar @ 40° C

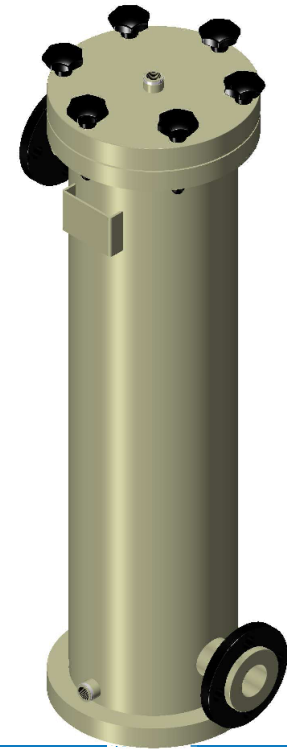

Specifications

Materials

Housing	Polypropylene (PP)
	Polyethylene (HD-PE)
Bolts	Stainless steel
O-ring	EPDM/FPM

Dimensions

Diameter JBF-1	250 mm
Diameter JBF-2	250 mm
Bag length	Size 1, Size 2

Other

Inlet/Outlet	DN 25 to 100
	½" to 2"
Drains/vent	½" BSP
Max. temperature	60° C
Max. pressure @ 40° C	6 bar or 10 bar

Benefits

- In- and outlet position can be chosen
- Pressure up to 10 bar
- High chemical resistance
- Can be in environments with high concentrations of salt
- Optimal for use in desalination systems
- Low maintenance
- Easy bag change

For Clear Solutions

Dimensions in mm	JBF-1		JBF-2		
	Inlet / outlet DN 32/40/50	Inlet / outlet DN 65/80	Inlet / outlet DN 32/40/50	Inlet / outlet DN 65/80	Inlet / outlet DN 100
A	575	560	905	890	880
B	115	125	115	125	135
C	420	450	420	450	450
D	250	250	250	250	250
E	315	315	315	315	315
F (6 bar/10 bar)	740/770	740/770	1050/1080	1050/1080	1160/1190

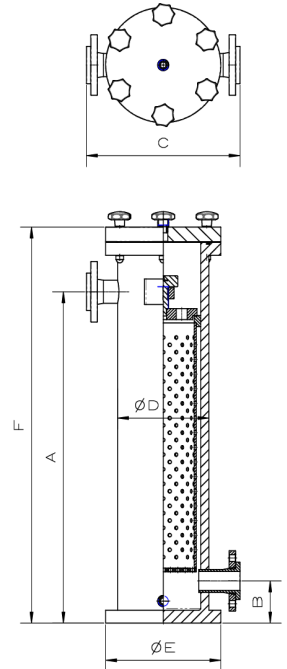

Pos	Name	Material
1	Handwheel	bakelite
2	Washer	Stainless steel
3	Vent 1/2" BSP	PP / HD-PE
4	Lid	PP / HD-PE
5	O-ring	EPDM / FMP
6	Spindel	PP / HD-PE
7	Pressure plate	PP / HD-PE
8	Lock beam	PP / HD-PE
9	Bolt set	Stainless steel
10	Inlet	PP / HD-PE
11	Name tag	PP / HD-PE
12	Housing	PP / HD-PE
13	Drain 1/2" BSP	PP / HD-PE
14	Outlet	PP / HD-PE

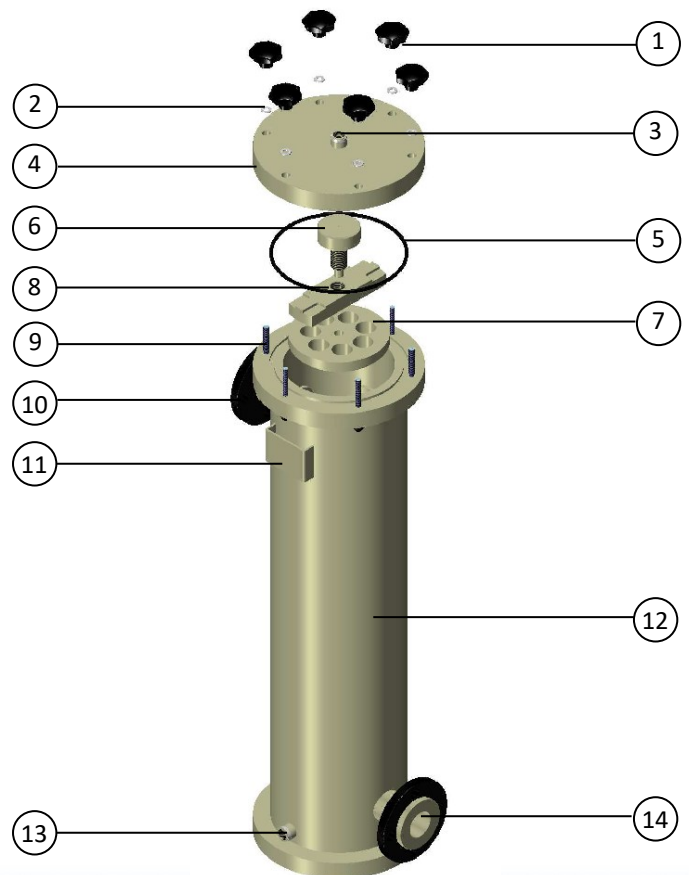

For Clear Solutions